

Simphonē™ Chorus



Executive-class telecommunications for world conquest.



SIMPHONĒ CHORUS AIRBORNE TELEPHONE SYSTEM

The industry's most advanced airborne telecommunications system, Simphonē (pronounced "symphony") Chorus combines TrueNorth's advanced ClearCall™ technology for superior voice quality—demonstrated as the industry's best—with the executive features and functions that let you conveniently manage your business empire from the air.

- Two built-in channels of all-digital, worldwide Iridium® Satcom
- Easy-to-use menu-driven handsets with noise-reduction technology
- Unlimited expandability for current and future networks, including broadband
- Large, full-color displays
- Custom handset materials, ringtones and screens
- Future-proof modular design
- Support for Inmarsat classic Aero-H/H+/I Satcom voice
- Integrated broadband data router with DHCP
- Wi-Fi IEEE 802.11 b/g with power control
- Support for Wi-Fi enabled mobile Smartphones
- Support for Inmarsat SwiftBroadBand™ voice
- Unmatched 3-year warranty
- Ideal for fixed-wing and helicopter use



EXECUTIVE CAPABILITY

Built to let your aircraft operate as an office anywhere in the world, the executive-class Simphonē Chorus is the epitome of communications control. Add fax, Inmarsat® Satcom and broadband data. Enjoy Wi-Fi support for your BlackBerry® or iPhone®. Expand your voice capacity without adding a second antenna. Customize your handsets to match your aircraft's interior. With Simphonē Chorus, you get it all!

SIMPHONĒ CHORUS SPECIFICATIONS

- **Input Power:** 28VDC (44W maximum)
- **Dimensions:** 4MCU (ARINC 600 form factor)
- **Mass:** 11.8 lb. (5.35 Kg)
- **Cooling:** Convection (inside cabin)
Forced air (outside cabin)
- **Operating Temperature:**
LRU, PM: -40°C to +70°C
CNDU, Handset: -15°C to +55°C
- **Altitude:** LRU, PM: 50,000 ft. (15,240 m.)
CNDU, Handset: 15,000 ft. (4,572 m.)
- **Environmental:** RTCA/DO-160E
- **Software:** RTCA/DO-178B Level E
- **Iridium:** Integrated dual Iridium voice and data (single antenna)
- **Interfaces:** Dual ARINC 746 CEPT-E1
Dual Analog Interface
Dual IEEE 802.3 10/100 Base-T
Scalable Fast Ethernet
Integrated broadband data router
- **Wi-Fi:** IEEE 802.11 b/g with external discrettes and power control; supports WPA2 and WEP
- **Codecs:** G.711
- **Protocols:** SIP, ARINC 746 (CEPT-E1), ARINC 781 (3G PPP)
- **Handset:** Full-color, menu-driven display, available in custom colors and materials

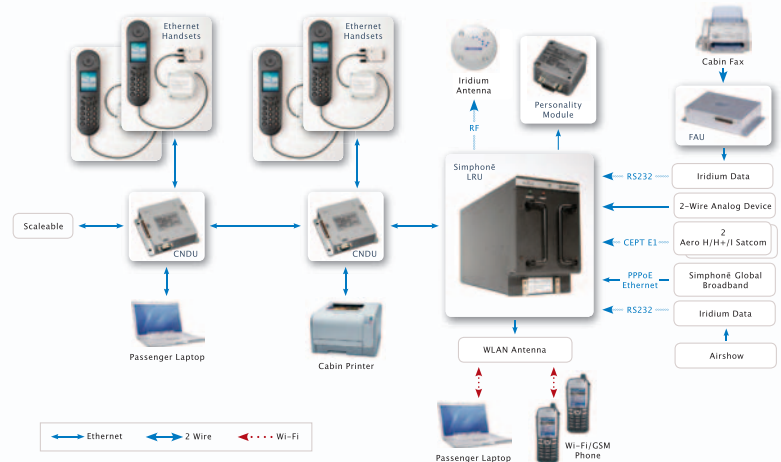

THE SIMPHONĒ DIFFERENCE

Simphonē system executive-class advantages:

Advanced ClearCall™ technology for superior voice quality

Two built-in channels of worldwide Iridium Satcom

Easy-to-use menu-driven handsets

Compact, one-box packaging for simple installation

“Future-proof” modular architecture for unlimited life and unlimited networking

Unmatched personalization options

Designed, manufactured and supported by TrueNorth to a higher executive standard

Three-year warranty

TRUENORTH AVIONICS, INC.

141 Bentley Avenue, Suite B • Ottawa, ON K2E 6T7 Canada • www.truenorthavionics.com
Phone: 613.224.3301 • Toll-free in US & Canada: 877.610.0110 • Fax: 613.224.0954